

RoHS compliant

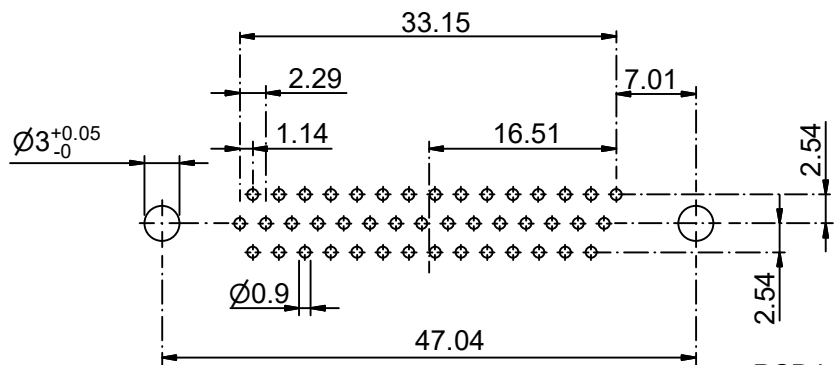
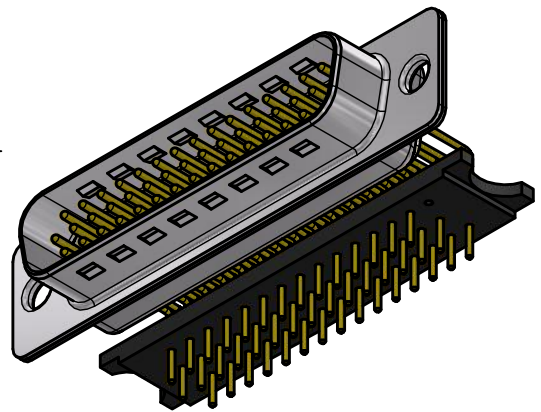
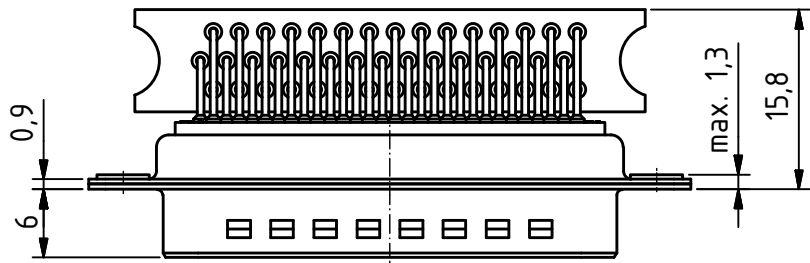
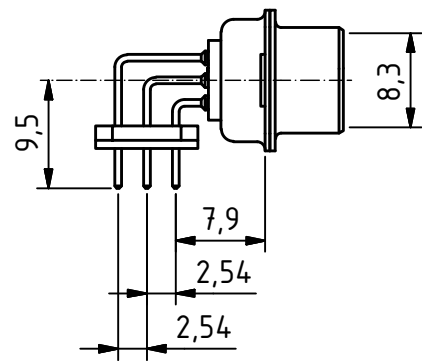
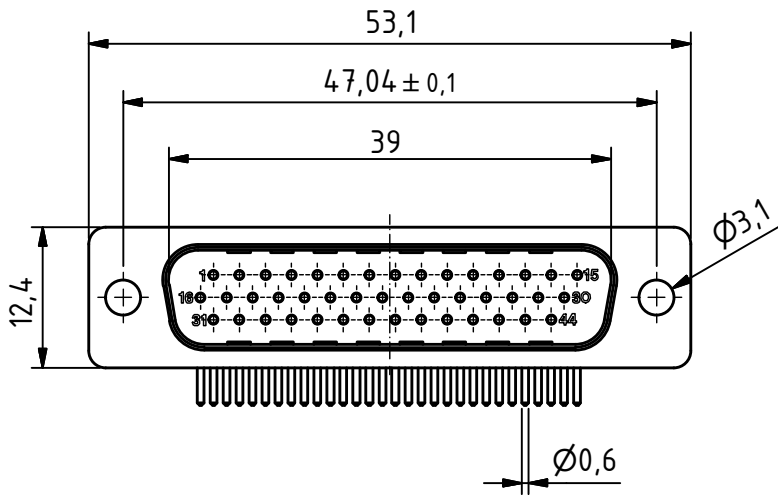

PCB Layout
tolerances +/-0.1

General tolerances (Deltron standard)	size in mm			
	> 0.5	up to 3	> 3	> 30
	up to 3	up to 6	up to 30	up to 120
tolerances				
	±0.1	±0.2	±0.2	±0.3

MATERIALS

- Insulator: Thermoplastic UL 94-V-0 white
- Contact: Machined / Copper alloy
- Contact finish: Quality class 2
- Shell: steel tin plated

CHARAKTERISTICS

- Working voltage: 60V
- Current rating: 5A
- Contact resistance: max. 10mΩ - DIN41652
- Insulation resistance: >5GΩ
- Temperature range: -55° to +125°C

modification	Rev.	Rev.	Rev.	DE009840 part no.		
	Rev.	Rev.	Rev.			
HD-D44PYC/2	1.5:1 scale	drawn	28.06.2012	mr		
		checked				
		approved				
 CONNECT 2 CUSTOMIZE		Industrie Neuhof 8c CH-3422 Kirchberg www.d-sub.swiss		K060911 drawing no.		