

No.	Changes and/or Note No.	Date	Sign	No.	Changes and/or Note No.	Date	Sign

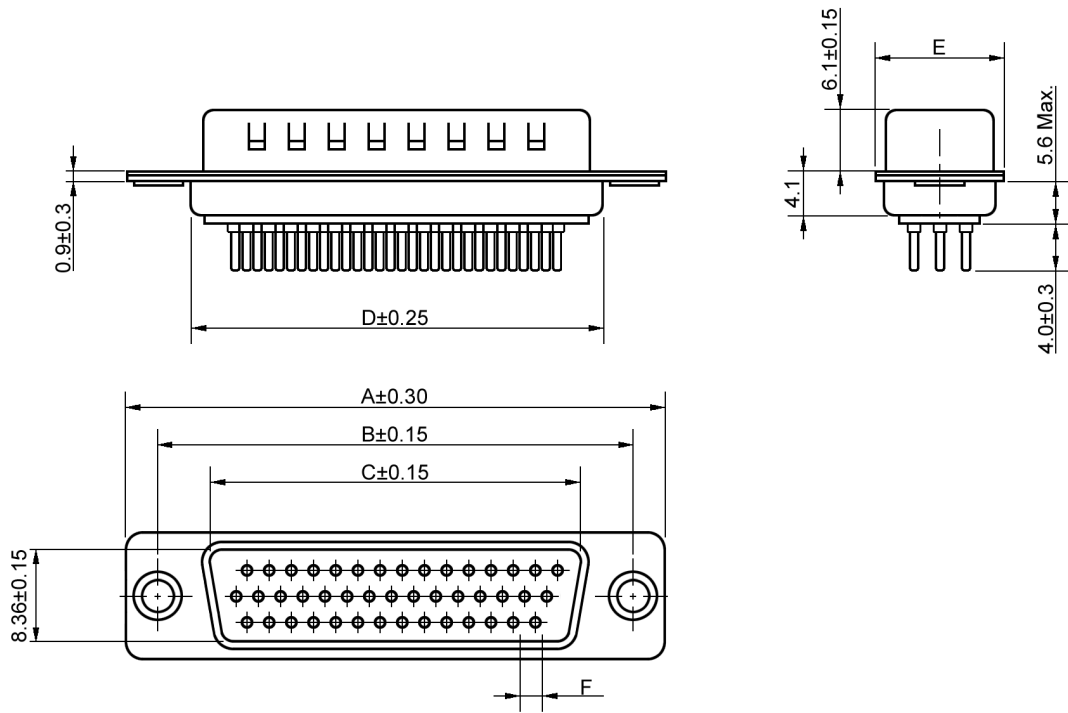

UNIT: (mm)

### DIMENSIONS

Size:	A	B	C	D	E	F	Part No:
15P	30.80	25.00	16.92	19.20	12.60	2.29	2103-0400-01
26P	39.20	33.30	25.25	27.70	12.60	2.29	2103-0400-02
44P	53.10	47.10	38.96	41.10	12.60	2.29	2103-0400-03
62P	69.40	63.50	55.42	57.30	12.60	2.41	2103-0400-04
78P	67.00	61.00	52.81	55.10	15.30	2.41	2103-0400-05

### MATERIAL SPECIFICATIONS:

Shell: Steel, Tin Plated (Standard)  
 Insulator: Glass Filled PBT, UL 94 V-0  
 Contacts: Brass, Machined Pins  
 Gold over Nickel

### TECHNICAL SPECIFICATIONS:

Current Rating: 5 Amp  
 Contact Resistance: 15 mΩ Max.  
 Insulator Resistance: 1000 MΩ Min.  
 Test Voltage: 500V AC for 1 Minute  
 Operating Temperature: -55°C to +105°C

DATE 2011-08-03	DRAWN MRR	SCALE	MATERIAL TYPE
	APPROVED		REPLACES



**HDD-xx-MTBM**  
 High Density Male Dip Solder Conn.  
 Machined Contact Pins



DRAWING No.

2103-0400-0x